

# Quick Start Guide

---

2.8-inch Linux Visible Light Product

Version: 1.0

# 1. Overview

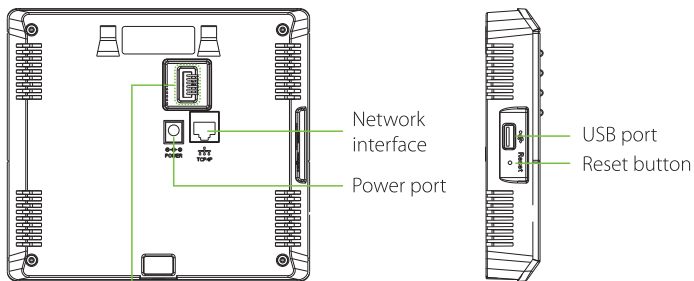
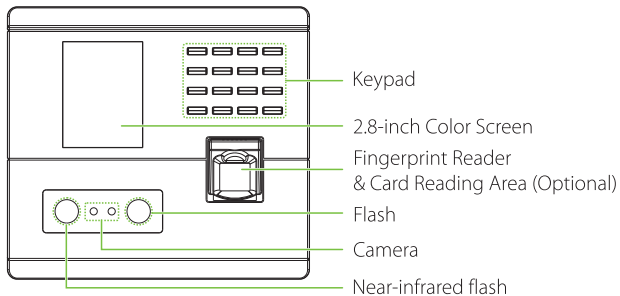

NC1	} Lock
COM1	
NO1	
SEN	} Sensor
GND	
BUT	} Button

## 2. Device Installation

### ❖ Install on the wall

- ① Attach the mounting template sticker to the wall, and drill holes according to the mounting paper.
- ② Fix the back plate on the wall using wall mounting screws.
- ③ After passing the wires through the wiring hole and connecting them to the device, and then attach the device to the back plate from top to bottom.
- ④ Fasten the device to the back plate with a security screw.

1

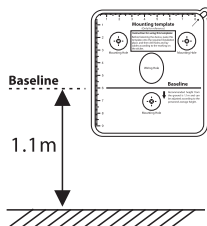

2

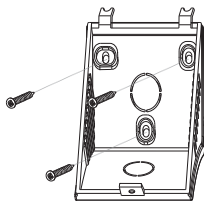

3

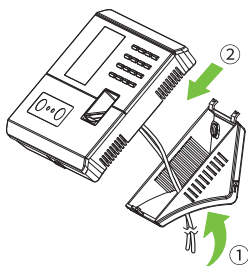

4

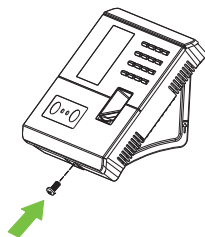

### 3. Standalone Installation

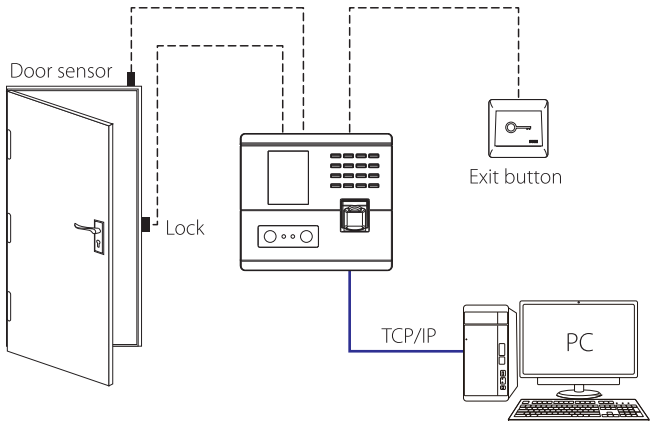

### 4. Door Sensor & Exit Button Connection

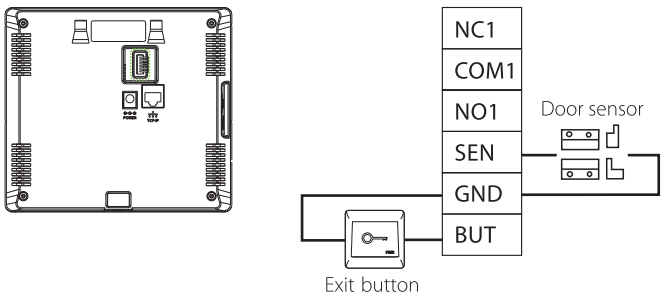

## 5. Lock Relay Connection

The system supports Normally Opened Lock and Normally Closed Lock. The **NO LOCK** (normally unlocked when powered) is connected with 'NO' and 'COM' terminals, and the **NC LOCK** (normally locked when powered) is connected with 'NC' and 'COM' terminals. Take NC Lock as an example below:

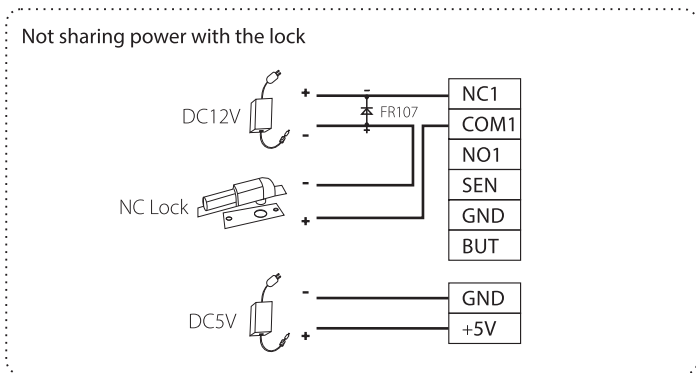

## 6. Power Connection

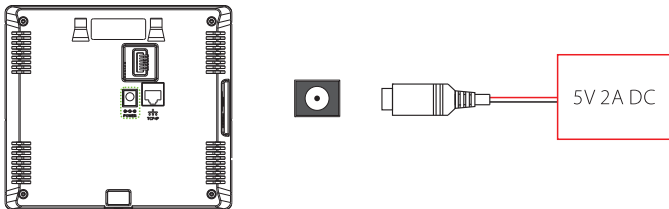

- Recommended power supply: **5V - 2A**
- To share the power with other devices, use a power supply with higher current ratings.

## 7. Ethernet Connection

Connect the device and computer software over an Ethernet cable. As shown in the example below:

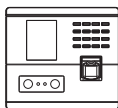

Default IP address: 192.168.1.201  
Subnet mask: 255.255.255.0

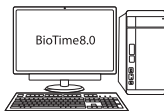

IP address: 192.168.1.130  
Subnet mask: 255.255.255.0

Click on **[Comm.] > [Ethernet] > [IP Address]**, input the IP address and click on **[OK]**.

**Note:** In LAN, the IP addresses of the server (PC) and the device must be in the same network segment while connecting to the BioTime 8.0 software.

## 8. Quick Start



### User registration

#### a. Registering on the device

Press **[M/OK] > [Main Menu] > [User Mgt.] > [New User]**. Enter User ID, Name, User Role, Department, Verification Mode and register Face, Fingerprint and Password, to register a user.

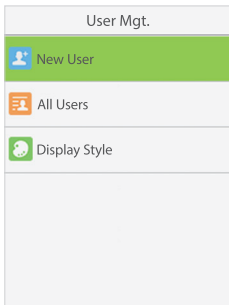
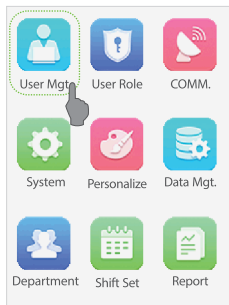

New User	
User ID	1
Name	
User Role	Normal User
Department	
Verification Mode	Password/Fingerprint/Face
Fingerprint	0

## b. Registering on the software (BioTime 8.0)

Please set the IP address and cloud service server address on the device.

1. Click **[Device] > [Device] > [Add]** to add the device to the software.

When the device's server address and port are set, it can automatically be added.

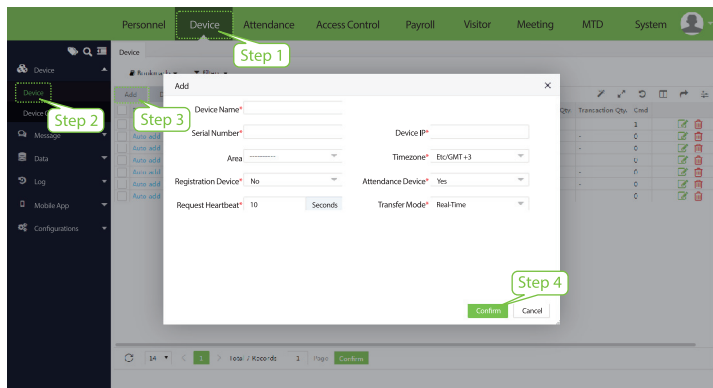

2. Click **[Personnel] > [Employee] > [Employee] > [Add]** to register users in the software.
3. Synchronize personnel on the software to devices in the corresponding area.
4. In the personnel list, select an employee (or employees) and click **[More] > [Synchronize to Device]** to access the confirmation interface for synchronizing.

For more details, please refer to the BioTime 8.0 User Manual.

## c. Registering on the phone

Once the BioTime 8.0 software is installed, users can enroll face via a browser application on their mobile phone.

To register visible light comparison photos to verify and punch on the visible light device, follow the steps below:

1. Choose **[Device] > [Data] > [Bio-photo] > [QR Code]** to access the QR Code getting interface.
2. Scan the QR code via the browser and enroll the user's face. Users can also input the **http://server\_ip\_address:server\_port/v1Register/** on the browser's search bar manually as well. The following interface is displayed after successful scanning:

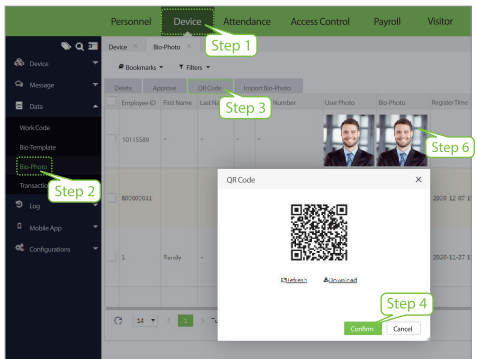
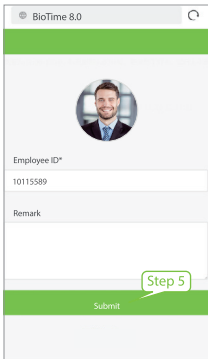

## User Authentication

The terminal can detect the face within a range of 0.3m to 1.5m. The device switches to the face verification interface automatically once it detects a change in environmental brightness. The verification result shows the registered image and personnel details.

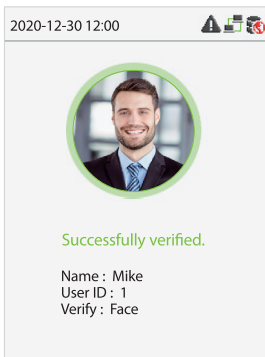

## View records

View records on the software

Click [Device] > [Data] > [Transaction] on the software to view the records.

## 9. Access Control Settings

Press [M/OK] > [Access Control] to enter the access control management interface and set relevant parameters of access control.

Access Control	
Access Control Options	

Access Control Options	
Door Lock Delay (s)	10
Door Sensor Delay (s)	10
Door Sensor Type	Normal Close (NC)
Door Alarm Delay (s)	30
Speaker Alarm	<input type="checkbox"/>

## 10. Ethernet and Cloud Server Settings

Press [M/OK] > [Comm.] > [Ethernet] to set the network parameters. If the TCP/IP communication of the device is successful, the icon  will be displayed in the upper right corner of the standby interface.

Press [M/OK] > [Comm.] > [Cloud Server Setting] to set the server address and server port, that is, the IP address and port number of the server after the software is installed. If the device communicates with the server successfully, the icon  will be displayed in the upper right corner of the standby interface.

Ethernet	
IP Address	192.168.1.201
Subnet Mask	255.255.255.0
Gateway	0.0.0.0
DNS	0.0.0.0
TCP COMM. Port	4370
DHCP	<input type="checkbox"/>

Cloud Server Setting	
Server Mode	ADMS
Enable Domain Name	<input type="checkbox"/>
Server Address	0.0.0.0
Server Port	8081
Enable Proxy Server	<input type="checkbox"/>
HTTPS	<input type="checkbox"/>

