

2.8-inch Visible Light product Installation Guide

How to install the device?

1

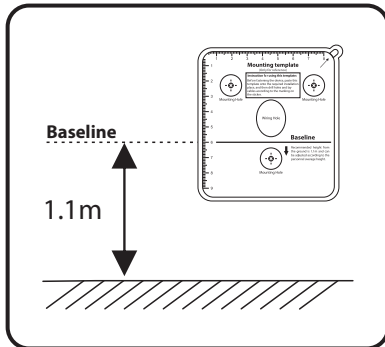

Attach the mounting template sticker to the wall, and drill holes according to the mounting paper.

2

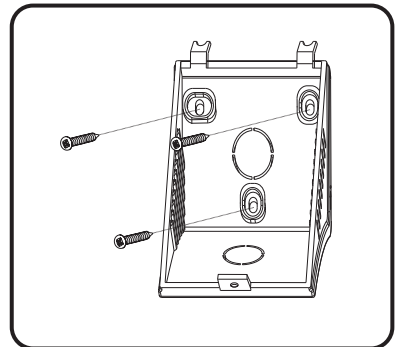

Fix the back plate on the wall using wall mounting screws.

3

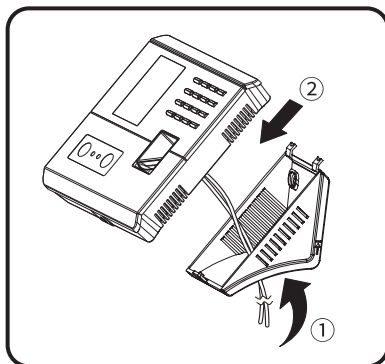

After passing the wires through the wiring hole and connecting them to the device, and then attach the device to the back plate from top to bottom.

4

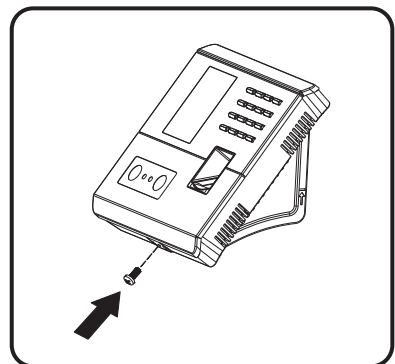

Fasten the device to the back plate with a security screw.

Wiring Diagram

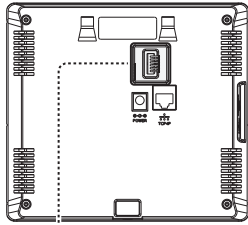

Terminals

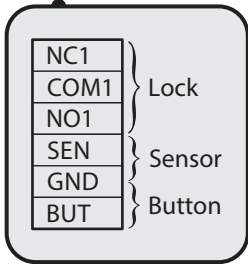

Door Sensor & Exit Button Connection

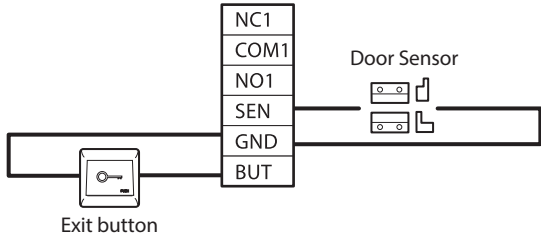

Lock Relay Connection

Not sharing power with the lock

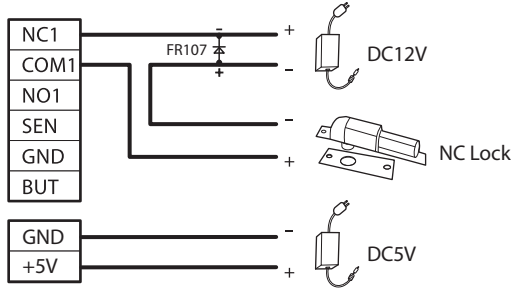

Power Connection

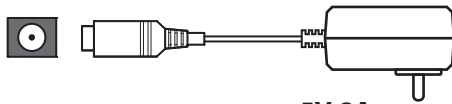

1. Recommended power supply: **5V-2A**
2. To share the power with other devices, use a power supply with higher current ratings.

Ethernet Connection

Connect the device and computer software over an Ethernet cable.

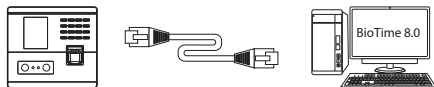

Default IP address: 192.168.1.201
Subnet mask: 255.255.255.0

IP address: 192.168.1.130
Subnet mask: 255.255.255.0

Note: In LAN, IP addresses of the server (PC) and the device must be in the same network segment when connecting to BioTime 8.0 software. Click on **[Comm.]** > **[Ethernet]** > **[IP Address]**, input the IP address and click on **[OK]**.



<http://document.guide/>

Scan the QR Code
and Download
the User Manual,
Installation Guide
and Quick Start Guide